

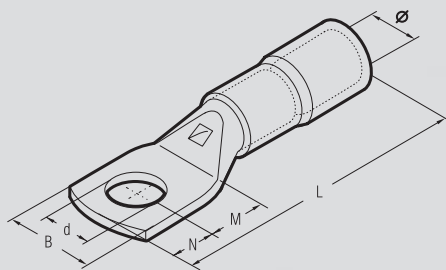

ANE-M



ANE-M series terminals are manufactured from electrolytic copper tube annealed and tin plated.

The interior of the Nylon insulation sleeve is funnel shaped so as to ensure complete and easy introduction of the conductor strands.

The Nylon insulated sleeve eliminates the need to insulate the terminal by either taping or using heat shrinkable tubes.

Furthermore the Nylon sleeve avoids the possibility of conductor breakage at the barrel entrance.

The items tabulated all feature black insulated sleeves, other coloured sleeves are available against specific request.

In order to achieve the best electrical and mechanical performance it is suggested that they are crimped using dies and tools specifically developed for this purpose by Cembre.

Conductor Size Flexible sqmm	Ø Stud mm	Ref.	Dimensions mm						Quantity Box/Bag	Mechanical Tools		Hydraulic Tools			
			Ø	B	M	N	L	d							
10	4	ANE 2-M 4	8,0	10,0	5,0	4,0	34,1	4,3	500/100	HMN 3	HMN 4	TMN 70	TMN 120	HT 51 RH 50 B 51	ECWH3D
	5	ANE 2-M 5	8,0	10,0	6,5	6,0	37,6	5,3	500/100						
	6	ANE 2-M 6	8,0	11,0	7,0	6,0	38,1	6,4	500/100						
	8	ANE 2-M 8	8,0	15,0	9,0	8,0	42,1	8,4	500/100						
	10	ANE 2-M 10	8,0	18,0	11,0	10,0	46,1	10,5	500/100						
	12	ANE 2-M 12	8,0	19,0	14,0	12,0	51,1	13,2	500/100						
16	4	ANE 3-M 4	9,2	11,5	5,0	4,0	38,6	4,3	500/100	HMN 3	HMN 4	TMN 70	TMN 120	HT 51 RH 50 B 51	ECWH3D
	5	ANE 3-M 5	9,2	11,5	6,5	6,0	42,1	5,3	500/100						
	6	ANE 3-M 6	9,2	11,5	7,0	6,0	42,6	6,4	500/100						
	8	ANE 3-M 8	9,2	15,0	9,0	8,0	46,6	8,4	500/100						
	10	ANE 3-M 10	9,2	18,0	11,0	10,0	50,6	10,5	500/100						
	12	ANE 3-M 12	9,2	20,0	14,0	12,0	55,6	13,2	300/100						
25	4	ANE 5-M 4	11,1	14,0	5,0	4,0	41,0	4,3	300/100	HMN 3	HMN 4	TMN 70	TMN 120	HT 51 RH 50 B 51	ECWH3D
	5	ANE 5-M 5	11,1	14,0	6,5	6,0	44,5	5,3	300/100						
	6	ANE 5-M 6	11,1	14,0	7,0	6,0	45,0	6,4	300/100						
	8	ANE 5-M 8	11,1	15,0	9,0	8,0	49,0	8,4	300/100						
	10	ANE 5-M 10	11,1	18,0	11,0	10,0	53,0	10,5	300/100						
	12	ANE 5-M 12	11,1	21,0	14,0	12,0	58,0	13,2	300/100						
35	6	ANE 7-M 6	13,6	17,0	7,0	6,0	50,0	6,4	200/100	HMN 3	HMN 4	TMN 70	TMN 120	HT 51 RH 50 B 51	ECWH3D
	8	ANE 7-M 8	13,6	17,0	9,0	8,0	54,0	8,4	200/100						
	10	ANE 7-M 10	13,6	19,0	11,0	10,0	58,0	10,5	200/100						
	12	ANE 7-M 12	13,6	21,0	14,0	12,0	63,0	13,2	200/100						
	6	ANE 10-M 6	13,8	19,0	8,0	7,0	55,0	6,4	200/50						
	8	ANE 10-M 8	13,8	19,0	9,0	8,0	57,0	8,4	200/50						
50	10	ANE 10-M 10	13,8	20,0	11,0	10,0	61,0	10,5	200/50	HMN 3	HMN 4	TMN 70	TMN 120	HT 51 RH 50 B 51	ECWH3D
	12	ANE 10-M 12	13,8	21,0	14,0	12,0	66,0	13,2	150/50						
	6	ANE 14-M 6	15,8	21,0	8,0	7,0	61,0	6,4	100/25						
	8	ANE 14-M 8	15,8	21,0	9,0	8,0	63,0	8,0	100/25						
	10	ANE 14-M 10	15,8	21,0	11,0	10,0	67,0	10,5	100/25						
	12	ANE 14-M 12	15,8	22,0	14,0	12,0	72,0	13,2	100/25						
70	14	ANE 14-M 14	15,8	25,0	16,0	14,0	76,0	15,0	100/25	HMN 3	HMN 4	TMN 70	TMN 120	HT 51 RH 50 B 51	ECWH3D



NYLON INSULATED COPPER TUBE LUGS

ANE-M

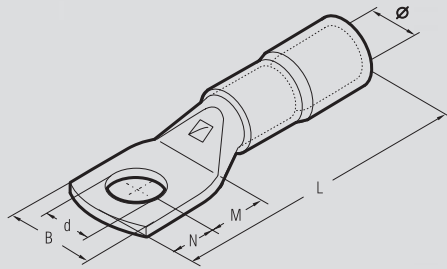

Conductor Size Flexible sqmm	Ø Stud mm	Ref.	Dimensions mm						Quantity Box/Bag	Mechanical Tools	Hydraulic Tools	
			Ø	B	M	N	L	d				
95	8	ANE 19-M 8	18,0	25,0	9,0	8,0	73,0	8,4	50/25	TNN 120	RH 50	B 51
	10	ANE 19-M 10	18,0	25,0	11,0	10,0	77,0	10,5	50/25			
	12	ANE 19-M 12	18,0	25,0	14,0	12,0	82,0	13,2	50/25			
	14	ANE 19-M 14	18,0	25,0	16,0	14,0	86,0	15,0	50/25			
120	16	ANE 19-M 16	18,0	27,0	18,0	16,0	80,0	17,0	50/25			
	10	ANE 24-M 10	20,0	28,5	11,0	10,0	77,7	10,5	50/25		RH 51	ECW-H3D
	12	ANE 24-M 12	20,0	28,5	14,0	12,0	86,5	13,2	50/25			
	14	ANE 24-M 14	20,0	28,5	16,0	14,0	88,5	15,0	50/25			
16	ANE 24-M 16	20,0	28,5	18,0	16,0	90,5	17,0	50/25				
150	12	ANE 30-M 12	23,0	31,5	16,0	14,0	101,0	13,2	30/15		HT 51	ECW-H3D
	14	ANE 30-M 14	23,0	31,5	18,0	16,0	105,0	15,0	30/15			
	16	ANE 30-M 16	23,0	31,5	19,0	17,0	107,0	17,0	30/15			
	20	ANE 30-M 20	23,0	31,5	22,0	20,0	113,0	21,0	30/15			





NYLON INSULATED COPPER TUBE LUGS

for extra flexible copper conductors

ANE-M

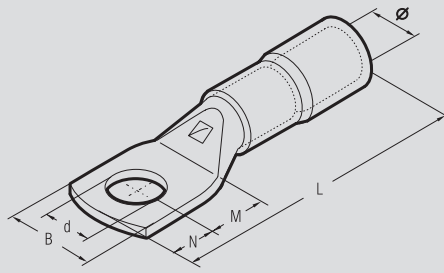

Conductor Size Extra Flexible sqmm	Ø Stud mm	Ref.	Dimensions mm						Quantity Box/Bag	Mechanical Tools	Hydraulic Tools	
			Ø	B	M	N	L	d			ECWH3D	
35	6	ANE 9-M 6/15	13,6	15,0	8,0	7,0	54,0	6,4	200/50	TNN 70 TNN 120	HT 51 RH 50 B 51	HT 120 and tools and heads with 130 kN crimping force
	8	ANE 9-M 8	13,6	17,0	9,0	8,0	56,0	8,4	200/50			
	10	ANE 9-M 10	13,6	18,5	11,0	10,0	60,0	10,5	200/50			
	12	ANE 9-M 12	13,6	21,0	14,0	12,0	65,0	13,2	200/50			
50	6	ANE 12-M 6/15	15,7	15,0	8,0	7,0	59,5	6,4	100/25			
	8	ANE 12-M 8	15,7	19,8	9,0	8,0	61,5	8,4	100/25			
	10	ANE 12-M 10	15,7	19,8	11,0	10,0	65,5	10,5	100/25			
	12	ANE 12-M 10/19	15,7	19,0	11,0	10,0	65,5	10,5	100/25			
70	12	ANE 12-M 12	15,7	22,0	14,0	12,0	70,5	13,2	100/25			
	6	ANE 17-M 6	17,9	23,0	8,0	7,0	63,8	6,4	100/25			
	8	ANE 17-M 8	17,9	23,0	9,0	8,0	65,8	8,4	100/25			
	10	ANE 17-M 10	17,9	23,0	11,0	10,0	69,8	10,5	100/25			
	10	ANE 17-M 10/19	17,9	19,0	11,0	10,0	69,8	10,5	100/25			
	12	ANE 17-M 12	17,9	23,0	14,0	12,0	74,8	13,2	100/25			
95	14	ANE 17-M 14	17,9	25,0	15,5	12,0	76,3	15,0	100/25			
	16	ANE 17-M 16	17,9	27,0	16,5	13,5	78,8	17,0	100/25			
	8	ANE 20-M 8	20,0	27,0	9,0	8,0	70,6	8,4	50/25			
	10	ANE 20-M 10	20,0	27,0	11,0	10,0	74,6	10,5	50/25			
120	12	ANE 20-M 12	20,0	27,0	14,0	12,0	79,6	13,2	50/25			
	14	ANE 20-M 14	20,0	27,0	15,5	12,0	81,1	15,0	50/25			
	16	ANE 20-M 16	20,0	27,0	16,5	13,5	83,6	17,0	50/25			
	10	ANE 29-M 10	22,4	30,0	11,0	10,0	81,5	10,5	50/25			
	12	ANE 29-M 12	22,4	30,0	14,0	12,0	86,5	13,2	50/25			
	14	ANE 29-M 14	22,4	30,0	15,5	12,0	88,5	15,0	50/25			
150	16	ANE 29-M 16	22,4	30,0	16,5	13,5	90,5	17,0	50/25			
	20	ANE 29-M 20	22,4	30,0	22,0	20,0	102,5	21,0	50/25			
	12	ANE 35-M 12	25,0	34,2	16,0	14,0	95,0	13,2	30/15			
	14	ANE 35-M 14	25,0	34,2	18,0	16,0	99,0	15,0	30/15			
150	16	ANE 35-M 16	25,0	34,2	19,0	17,0	101,0	17,0	30/15			
	20	ANE 35-M 20	25,0	34,2	22,0	20,0	107,0	21,0	30/15			

These terminals are particularly recommended for use with extra flexible conductors on for instance, welding machines.

ANE-M series terminals are manufactured from electrolytic copper tube annealed and tin plated.

The interior of the Nylon insulation sleeve is funnel shaped so as to ensure complete and easy introduction of the conductor strands.

The Nylon insulated sleeve eliminates the need to insulate the terminal by either taping or using heat shrinkable tubes.

Furthermore the Nylon sleeve avoids the possibility of conductor breakage at the barrel entrance.

The items tabulated all feature black insulated sleeves, other coloured sleeves are available against specific request.

In order to achieve the best electrical and mechanical performance it is suggested that they are crimped using dies and tools specifically developed for this purpose by Cembre.

NYLON INSULATED PIN TERMINALS



ANE-P

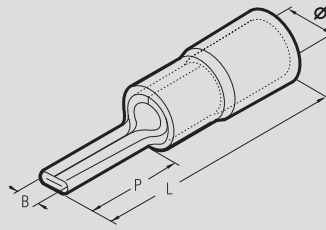

ANE-P series terminals are made from electrolytic copper, rolled, tin plated and brazed. The interior of the Nylon insulation sleeve is funnel shaped so as to ensure complete and easy introduction of the conductor strands.

In order to achieve the best electrical and mechanical performance it is suggested that they are crimped using dies and tools specifically developed for this purpose by Cembre.

Conductor Size Flexible sqmm	Ref.	Dimensions mm				Quantity Box/Bag	Mechanical Tools			Hydraulic Tools		
		Ø	B	P	L		HNN 3	HNN 4	TNN 70	TNN 120	HT 51 RH 50 B 51	HT 120 and tools and heads with 130 kN crimping force
10	ANE 2-P 12	8,0	4,3	14,5	35,1	500/100						
16	ANE 3-P 14	9,2	5,5	18,0	41,1	500/100						
25	ANE 5-P 16	11,1	7,0	20,3	45,0	300/100						
35	ANE 7-P 20	13,6	8,0	24,5	55,0	200/50						

UNINSULATED PIN CONNECTORS



A-P

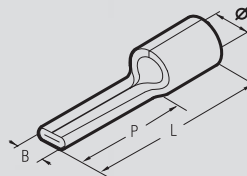

A-P series pin connectors are designed to terminate conductors into contact blocks.

They are manufactured from copper strip, rolled, brazed and tin plated.

Conductor Size sqmm	Ref.	Dimensions mm				Quantity Box/Bag	Mechanical Tools			Hydraulic Tools		
		Ø1	B	P	L		HN 1	HN 5	TN 70 SE	TN 120 SE	HT 45-E	HT 51 RH 50 B 51
10	A 2-P 12	4,8	4,3	14,5	23,5	1.500/100						
16	A 3-P 14	5,9	5,5	18,0	28,0	1.500/100						
25	A 5-P 16	7,0	7,0	20,3	32,0	1.000/100						
35	A 7-P 20	8,9	8,0	24,5	39,0	500/100						
50	A 10-P 25	10,0	9,5	26,0	45,0	250/50						
70	A 14-P 30	11,5	11,0	31,0	55,0	200/50						