

■ **Tubular cable lugs, stainless steel**
0.5 - 95 mm²
 Ring type

- For aggressive environmental factors
- Heat resistant up to 400°C

Characteristics

- Flat contact surface by special manufacturing processes

Material

- Stainless steel

Order info

- Also available in V4A material

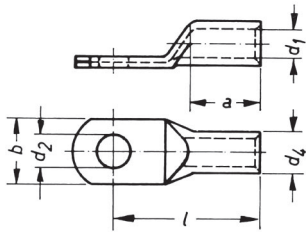

Cross-section mm ²	Size of bolt Ø	Part No.	Dimensions mm						Weight/ 100 pcs. ~ kg	pcs.
			d1	a	b	d2	d4	l		
0.5-1	M4	79V4	1.6	6	6.5	4.3	3.2	13	0.080	100
	M5	79V5	1.6	6	7.5	5.3	3.2	14	0.080	100
1.5-2.5	M4	80V4	3.0	8	9.0	4.3	5.0	17	0.260	100
	M5	80V5	3.0	8	9.0	5.5	5.0	17	0.190	100
	M6	80V6	3.0	8	9.5	6.5	5.0	19	0.215	100
4-6	M4	81V4	4.0	9	9.0	4.3	6.0	18	0.260	100
	M5	81V5	4.0	9	9.5	5.5	6.0	19	0.280	100
	M6	81V6	4.0	9	10.0	6.5	6.0	19	0.280	100
10	M5	82V5	5.0	10	12.5	5.5	8.0	22	0.710	100
	M6	82V6	5.0	10	12.5	6.5	8.0	22	0.780	100
	M8	82V8	5.0	10	15.0	8.5	8.0	25	0.780	100
16	M5	83V5	6.0	13	12.0	5.5	8.0	28	0.500	100
	M6	83V6	6.0	13	12.0	6.5	8.0	28	0.550	100
	M8	83V8	6.0	13	15.0	8.5	8.0	29	0.600	100
25	M6	84V6	7.0	15	14.0	6.5	10.0	30	1.210	50
	M8	84V8	7.0	15	16.0	8.5	10.0	32	1.850	50
35	M6	85V6	9.0	17	17.0	6.5	12.0	32	1.600	50
	M8	85V8	9.0	17	17.0	8.5	12.0	35	1.850	50
50	M6	86V6	10.0	19	20.0	6.5	14.0	37	2.800	50
	M8	86V8	10.0	19	20.0	8.5	14.0	37	2.600	50
	M10	86V10	10.0	19	20.0	10.5	14.0	39	2.800	50
	M12	86V12	10.0	19	20.0	13.0	14.0	43	2.960	50
70	M8	87V8	12.0	21	23.0	8.5	16.0	43	3.650	25
	M10	87V10	12.0	21	23.0	10.5	16.0	44	3.930	25
	M12	87V12	12.0	21	23.0	13.0	16.0	46	3.850	25
	M16	87V16	12.0	21	26.0	17.0	16.0	46	3.960	25
95	M8	88V8	14.0	25	26.0	8.5	18.0	48	4.650	25
	M10	88V10	14.0	25	26.0	10.5	18.0	48	5.610	25
	M12	88V12	14.0	25	26.0	13.0	18.0	49	5.540	25

► Tool: see chart page 57

■ **Butt-connector, stainless steel 0.5 - 95 mm²**

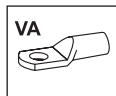

- For aggressive environmental factors
- Heat resistant up to 400°C

Characteristics

- With buttmarks for precise cable insertion

Material

- Stainless steel

Order info

- Also available in V4A material



Cross-section mm ²	Part No.	Dimensions mm			Weight/100 pcs. ~ kg	pcs.
		d1	d4	l		
0.5-1	79R	1.6	3.2	25	0.135	50
1.5-2.5	80R	3.0	5.0	25	0.250	50
4-6	81R	4.0	6.0	25	0.325	50
10	82R	5.0	8.0	25	0.360	50
16	83R	6.0	8.0	30	0.510	50
25	84R	7.0	10.0	35	1.100	25
35	85R	9.0	12.0	40	1.560	25
50	86R	10.0	14.0	45	2.670	25
70	87R	12.0	16.0	50	3.400	25
95	88R	14.0	18.0	55	4.300	25

► Tool: see chart page 57



■ **Tubular cable lugs, nickel 0.5 - 95 mm²**
Ring type

■ **Heat resistant up to 650°C**

Characteristics

- Flat contact surface by special manufacturing processes

Material

- high grade nickel

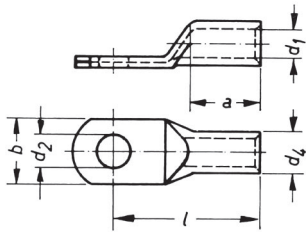

Cross-section mm ²	Size of bolt Ø	Part No.	Dimensions mm						Weight/100 pcs. ~ kg	pcs.
			d1	a	b	d2	d4	l		
0.5-1	M4	56N4	1.6	6	6.5	4.3	3.2	13	0.080	100
	M5	56N5	1.6	6	7.5	5.3	3.2	14	0.080	100
1.5-2.5	M4	57N4	2.3	6	7.0	4.3	3.9	13	0.105	100
	M5	57N5	2.3	6	7.5	5.3	3.9	14	0.105	100
	M6	57N6	2.3	6	9.5	6.5	3.9	16	0.130	100
4-6	M4	58N4	3.6	9	9.5	4.3	5.6	18	0.275	100
	M5	58N5	3.6	9	9.5	5.3	5.6	19	0.275	100
	M6	58N6	3.6	9	9.5	6.5	5.6	19	0.260	100
10	M5	59N5	4.5	10	12.0	5.5	6.5	21	0.340	100
	M6	59N6	4.5	10	12.0	6.5	6.5	22	0.360	100
16	M5	60N5	5.5	13	12.0	5.5	7.5	26	0.470	100
	M6	60N6	5.5	13	12.0	6.5	7.5	27	0.480	100
	M8	60N8	5.5	13	13.5	8.5	7.5	29	0.560	100
25	M6	61N6	7.0	15	14.0	6.5	10.0	30	1.200	50
	M8	61N8	7.0	15	16.0	8.5	10.0	32	1.320	50
35	M6	62N6	8.5	17	17.0	6.5	12.0	32	1.850	50
	M8	62N8	8.5	17	17.0	8.5	12.0	34	2.000	50
50	M8	63N8	10.0	19	20.0	8.5	14.0	37	2.900	50
	M10	63N10	10.0	19	20.0	10.5	14.0	39	3.100	50
70	M10	64N10	12.0	21	23.0	10.5	16.5	44	4.600	25
	M12	64N12	12.0	21	23.0	13.0	16.5	46	4.660	25
95	M10	65N10	13.5	25	26.0	10.5	18.0	48	5.550	25
	M12	65N12	13.5	25	26.0	13.0	18.0	49	5.600	25

► Tool: see chart page 57

■ **Tubular cable lugs, nickel 0.5 - 16 mm²**

Fork type

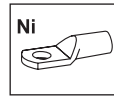

- Heat resistant up to 650°C
- For direct screw-mounting

Characteristics

- Flat contact surface by special manufacturing processes

Material

- high grade nickel

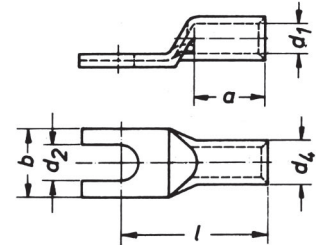

Cross-section mm ²	Size of bolt Ø	Part No.	Dimensions mm						Weight/100 pcs. ~ kg	pcs.
			d1	a	b	d2	d4	l		
0.5-1	M4	56C4	1.6	6	6.5	4.3	3.2	13	0.070	50
	M5	56C5	1.6	6	7.5	5.3	3.2	14	0.075	50
1.5-2.5	M4	57C4	2.3	6	7.0	4.3	3.9	13	0.095	50
	M5	57C5	2.3	6	7.5	5.3	3.9	14	0.095	50
	M6	57C6	2.3	6	9.5	6.5	3.9	16	0.110	50
4-6	M4	58C4	3.6	9	9.5	4.3	5.6	18	0.250	50
	M5	58C5	3.6	9	9.5	5.3	5.6	19	0.255	50
	M6	58C6	3.6	9	9.5	6.5	5.6	19	0.235	50
10	M5	59C5	4.5	10	12.0	5.5	6.5	21	0.320	50
	M6	59C6	4.5	10	12.0	6.5	6.5	22	0.340	50
16	M5	60C5	5.5	13	12.0	5.5	7.5	26	0.440	50
	M6	60C6	5.5	13	12.0	6.5	7.5	27	0.450	50
	M8	60C8	5.5	13	13.5	8.5	7.5	29	0.520	50

► Tool: see chart page 57

Electrical connection system

Tubular cable lugs and connectors - nickel, stainless steel



■ **Butt-connector, nickel 0.5 - 16 mm²**

■ **Heat resistant up to 650°C**

Characteristics

- With buttmarks for precise cable insertion

Material

- high grade nickel



Cross-section mm ²	Part No.	Dimensions mm			Weight/100 pcs. ~ kg	pcs.
		d1	d4	l		
0.5-1	62R	1.6	3.2	25	0.135	50
1.5-2.5	63R	2.3	3.9	25	0.170	50
4-6	64R	3.6	5.6	25	0.325	50
10	65R	4.5	6.5	25	0.360	50
16	66R	5.5	7.5	30	0.510	50

► Tool: see chart page 57

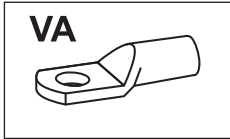

■ Tool application chart

Tubular cable lugs and butt-connectors made from stainless steel

Crimping range corresponds to nominal cross-section mm ²	Crimping tools		Tool type						Crimping profile	Page (Tool)
	Tools	Crimping head/adapter	Mechanical crimping tools	mechanical, electrical, pneumatic, crimping tools with interchangeable dies/heads	hand hydraulic crimping tools	Battery powered crimping tools	Hydraulic crimping systems	Hydraulic crimping heads		
0.5-16	K25		•						☺	258
	EK354					•			☺	324
10-50	K22			•					☺	276
	HK6022				•				☺	296
	EK22PLUS					•			☺	328
	PK22							•	☺	389
	THK22						•		☺	360
	HK60UNV + UA22					•			☺	309
	EK60UNV + UA22						•		☺	347
	PK60UNV + UA22							•	☺	405

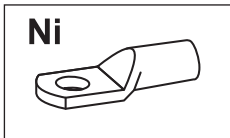

■ Tool application chart

Tubular cable lugs and butt-connectors made from nickel

Crimping range corresponds to nominal cross-section mm ²	Crimping tools		Tool type						Crimping profile	Page (Tool)
	Tools	Crimping head/adapter	Mechanical crimping tools	mechanical, electrical, pneumatic, crimping tools with interchangeable dies/heads	hand hydraulic crimping tools	Battery powered crimping tools	Hydraulic crimping systems	Hydraulic crimping heads		
0.5-16	K25		•						☺	258
	EK354					•			☺	324
10-50	K22			•					☺	276
	HK6022				•				☺	296
	EK22PLUS					•			☺	328
	PK22							•	☺	389
	THK22						•		☺	360
	HK60UNV + UA22					•			☺	309
	EK60UNV + UA22						•		☺	347
	PK60UNV + UA22							•	☺	405