

## Wall Stand-off



PART NUMBER	Panel Range	D	d	L	Unit Quantity
077 1000	1.0 - 13.0	18.80	12.00	25.20	100

Material: Anodised Steel  
Colour: Silver - satin finish

- For displaying glass/acrylic panels or frames
- Head & Cylinder supplied together
- Provides a neat and secure fixing

Maximum screw size: No.10 or M5  
(Screws not supplied)

RoHS Directive 2002/95/EC compliant

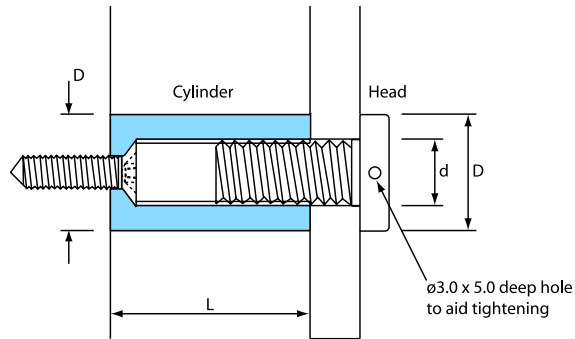

Point of Sale Accessories



## Suspended Ceiling Rail Clip



PART NUMBER	Maximum Panel Thickness	W	L	H	Unit Quantity
077 5000	2.0	19.5	20.0	12.0	100

Material: Polypropylene  
Colour: Natural/Translucent

- Attaches to suspended ceiling rails
- Quick and simple to install and is reusable

RoHS Directive 2002/95/EC compliant

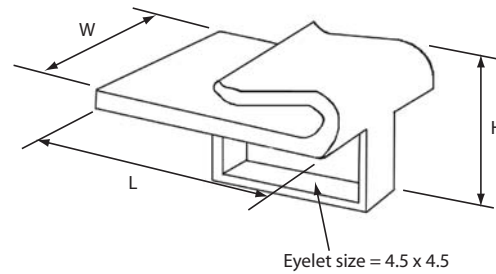

## Self Adhesive Ceiling Buttons



PART NUMBER	Material	W	L	Form	Unit Quantity
077 5001	Polystyrene	20.0	20.0	A	100
077 5002	Polystyrene	20.0	-	B	100
077 5003	Polystyrene	20.0	40.0	C	100
077 5004	ABS	30.0	30.0	D	100

Colour: White

- Supplied with adhesive foam on base
- Quick and simple to install

RoHS Directive 2002/95/EC compliant

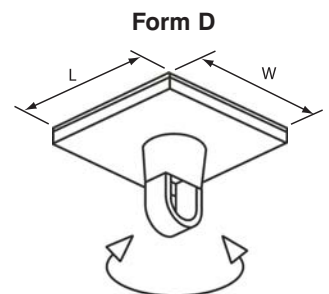
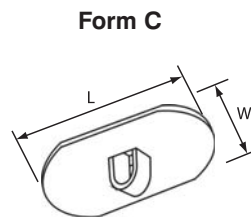
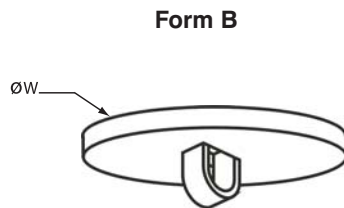
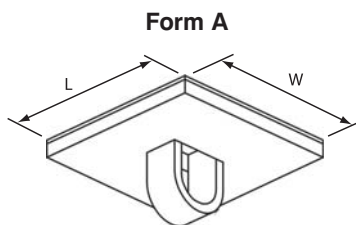

## Metal Hanging Hooks



PART NUMBER	Material	L	Form	Unit Quantity
077 4000	2.0 Dia Galvanized Steel	38.0	A	100
077 4001	2.0 Dia Galvanized Steel	39.0	B	100
077 4006	2.0 Dia Galvanized Steel	100.0	C	100
077 4007	2.0 Dia Galvanized Steel	150.0	C	100
077 4008	2.0 Dia Galvanized Steel	300.0	C	100
077 4009	2.0 Dia Galvanized Steel	400.0	C	100
077 4010	2.0 Dia Galvanized Steel	500.0	C	100
077 4011	Hook = 0.9 Galv. Steel Wire = 0.25 Steel	170 extending to 1000	D	100

Colour: Self

- Quick and simple to install
- Ideal for use with ceiling buttons

RoHS Directive 2002/95/EC compliant

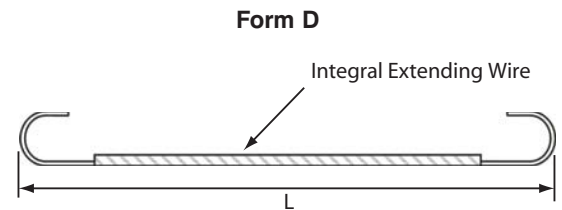
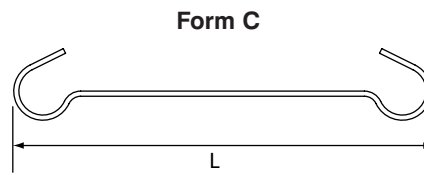
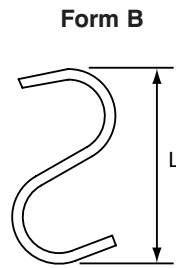
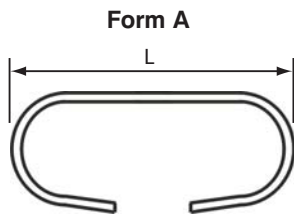

## Oval Pop Rings

PART NUMBER	A	B	C	Unit Quantity
077 3000	20.5	10.0	8.7	100
077 3001	50.9	24.0	26.0	100

Material: Polyethylene  
Colour: White

Note: Dimensions are for part in the closed position  
Ring thickness approx. 3.0

RoHS Directive 2002/95/EC compliant



- Quick and simple to install
- Reusable
- Ideal for hanging signs and light weight displays

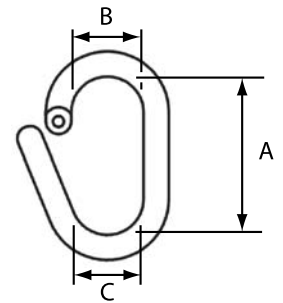

## S-Hanging Hooks

PART NUMBER	Colour	A	B	C	D	Unit Quantity
077 4002	Clear	38.0	17.5	10.3	31.0	100
077 4003	Clear	55.0	25.0	15.0	45.0	100
077 4004	White	38.0	17.5	10.3	31.0	100
077 4005	White	55.0	25.0	15.0	45.0	100

Material: Polystyrene

RoHS Directive 2002/95/EC compliant



- Quick and simple to install
- Reusable
- Ideal for hanging signs and light weight displays

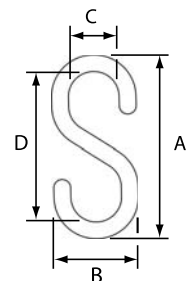



## Suction Cups

PART NUMBER	A	B	C	D	E	Form	Unit Quantity
077 2000	25.0	10.0	7.75	3.5	1.5	A	100
077 2001	40.0	15.0	14.75	9.5	2.5	A	100
077 2002	20.0	12.0	17.0	9.5	7.2	B	100
077 2003	50.0	20.0	17.0	11.0	8.0	B	100
077 2004	40.0	15.0	14.75	-	-	C	100
077 2005	47.0	17.0	17.0	11.75	6.8	D	100

Material: PVC (Form B pin: Acrylic)  
Colour: Clear

Note: Part numbers 077 2002 & 077 2003 are supplied with a removable Acrylic pin.

RoHS Directive 2002/95/EC compliant



- Quick and simple to install
- Reusable
- Ideal for hanging signs and light weight displays

3 Point of Sale Accessories

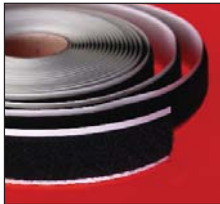
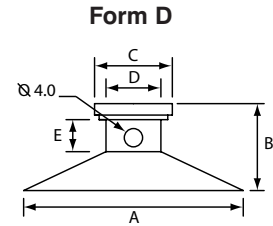
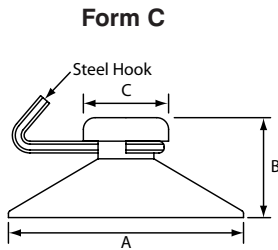
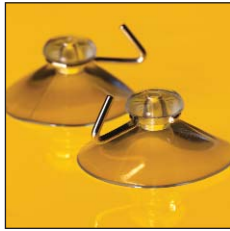
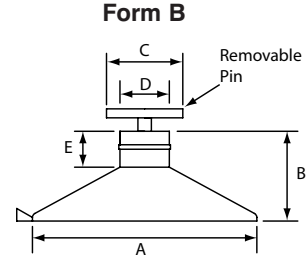
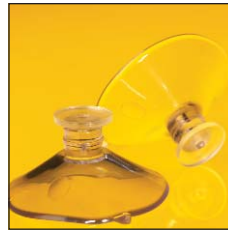
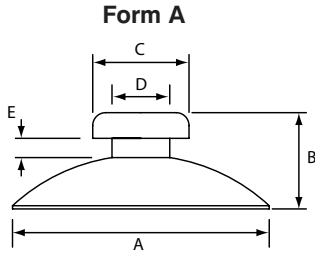

Roll Form



Coins

## VELCRO® Brand Fasteners: VELCRO® Brand Handy-Pack Range

PART NUMBER	Colour	Description	Roll Width/ Coin Diameter	Roll Length (Metres)	Adhesive Type	Unit Quantity
380 2300	White	Roll - Hook	20	5	PS14	1 roll
380 2301	White	Roll - Loop	20	5	PS14	1 roll
380 2302	Black	Roll - Hook	20	5	PS14	1 roll
380 2303	Black	Roll - Loop	20	5	PS14	1 roll
380 2304	Black	Roll - Hook	25	5	PS18	1 roll
380 2305	Black	Roll - Loop	25	5	PS18	1 roll
380 2306	White	Coins - Hook	13	5 (300 coins)	PS14	1 roll
380 2307	White	Coins - Loop	13	5 (300 coins)	PS14	1 roll
380 2308	Black	Coins - Hook	13	5 (300 coins)	PS14	1 roll
380 2309	Black	Coins - Loop	13	5 (300 coins)	PS14	1 roll
380 2310	White	Coins - Hook	22	5 (200 coins)	PS14	1 roll
380 2311	White	Coins - Loop	22	5 (200 coins)	PS14	1 roll
380 2312	Black	Coins - Hook	22	5 (200 coins)	PS14	1 roll
380 2313	Black	Coins - Loop	22	5 (200 coins)	PS14	1 roll

Adhesive PS14: General purpose rubber base adhesive, high tack-quick setting, achieves 90% bond strength in approx 1 hour

Adhesive PS18: Acrylic base adhesive offering exceptional strength for high temperature use. Can be used on surfaces containing plasticisers that are hard to adhere to.

Material: Woven Nylon

Binder Backing: Synthetic Resin

RoHS Directive 2002/95/EC compliant



- Non - Corrosive
- Adjustable - for ease of assembly
- Durable
- Ideal for exhibitions and point of purchase

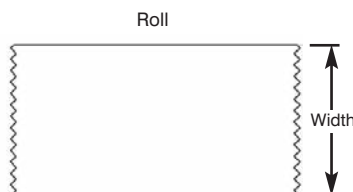
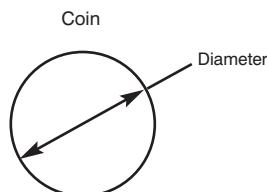

## Viking Screws



PART NUMBER	Colour	Mounting Hole Diameter	L	H	T	D	Unit Quantity
077 6000	Clear	5.5	12.7	14.0	9.0	13.5	100
077 6001	Black	5.5	12.7	14.0	9.0	13.5	100
077 6002	White	5.5	12.7	14.0	9.0	13.5	100
077 6003	Clear	5.5	25.4	14.0	9.0	13.5	100
077 6004	Black	5.5	25.4	14.0	9.0	13.5	100
077 6005	White	5.5	25.4	14.0	9.0	13.5	100

Material: Polystyrene

RoHS Directive 2002/95/EC compliant



Note: Nut and screw are supplied as a set.

- Quick and simple to install
- Reusable
- Ideal for hanging signs and light weight displays

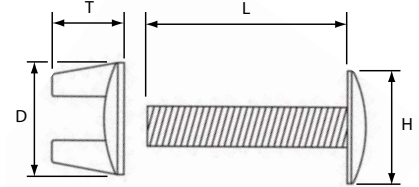

## Ratchet Screw Fasteners



PART NUMBER	Hole Size	Panel Range	A	B	L	Unit Quantity
070 7000	4.75	1.0 - 13.0	12.70	2.25	19.00	1,500
070 7001	4.75	1.0 - 19.5	12.70	2.25	25.00	1,500

Material: Polycarbonate

Colour: Clear

RoHS Directive 2002/95/EC compliant



- Moulded as one piece
- Push to set - unscrew to remove
- Low cost
- Clear material
- Unique product

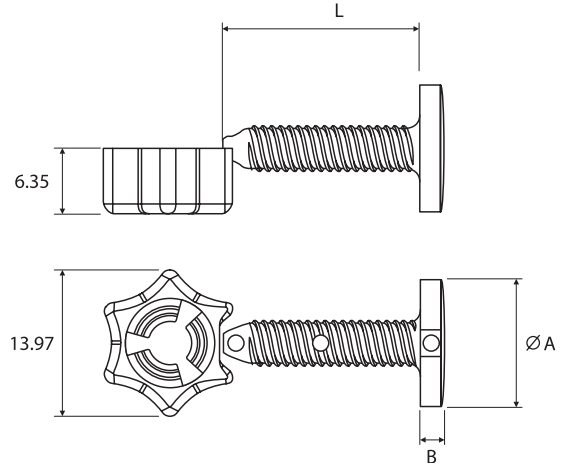

## Removable Ratchet Rivets



PART NUMBER	Colour	Hole Size	Panel Range	A	B	C	L	Type	Unit Quantity
070 8000	Natural	6.70	5.0 Max	12.00	2.75	-	3.75	Female	5,000
			5.0 Max	12.00	2.75	3.00	10.50	Male	5,000
070 8001	Black	6.70	5.0 Max	12.00	2.75	-	3.75	Female	5,000
			5.0 Max	12.00	2.75	3.00	10.50	Male	5,000

Material: Acetal

RoHS Directive 2002/95/EC compliant



Note: Male and Female parts are supplied together as a set

- Parts ratchet together and unscrew apart
- Provides rapid assembly
- Non-conductive
- Easy to use
- Unique design

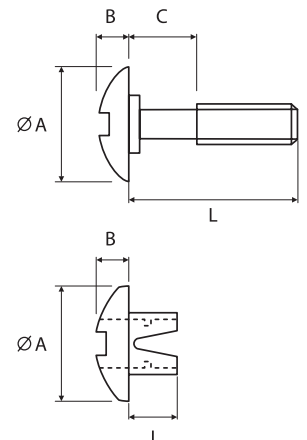

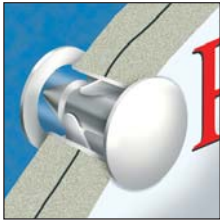

## Snap Rivets

PART NUMBER		Material	Colour	Panel Thickness	Hole Size	Head Dia.	Head Thickness	Unit Quantity
Male	Female							
071 2000	071 2001	Heat Stabilised Nylon	Black	4.31 - 4.82	8.13	15.87	1.57	1,000
071 3000	071 3001	Polycarbonate	Clear	4.31 - 4.82	8.13	15.87	1.57	1,000
071 1000	071 1001	Nylon	Natural	4.31 - 4.82	8.13	15.87	1.57	1,000
071 2015	071 2016	Heat Stabilised Nylon	Black	4.31 - 4.82	8.13	11.68	1.57	1,000
071 1015	071 1016	Nylon	Natural	4.31 - 4.82	8.13	11.68	1.57	1,000
071 2005	071 2001	Heat Stabilised Nylon	Black	5.6 - 6.1	8.13	15.87	1.57	1,000
071 3005	071 3001	Polycarbonate	Clear	5.6 - 6.1	8.13	15.87	1.57	1,000
071 1005	071 1001	Nylon	Natural	5.6 - 6.1	8.13	15.87	1.57	1,000
071 2010	071 2001	Heat Stabilised Nylon	Black	8.12 - 8.64	8.13	15.87	1.57	1,000
071 3010	071 3001	Polycarbonate	Clear	8.12 - 8.64	8.13	15.87	1.57	1,000
071 1010	071 1001	Nylon	Natural	8.12 - 8.64	8.13	15.87	1.57	1,000
071 1010	071 1017	Nylon	Natural	13.9 - 19.59	8.13	15.87	1.57	1,000

Assembled

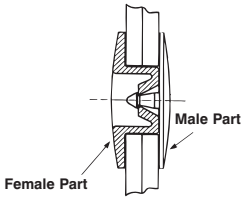

Male and Female parts are supplied unassembled and must be ordered separately using part numbers listed

RoHS Directive 2002/95/EC compliant



- Simple to use, no tooling required - just press together
- Gives neat finish appearance
- Ideal for both rigid and compressible materials
- Available in clear Polycarbonate - ideal for signs and displays

Point of Sale Accessories

3



## Ratchet Rivets

PART NUMBER	Colour	A Panel Thickness	B Head Dia.	C Head Height	Nominal Hole Size	Unit Quantity
070 5815	Black	3.0 to 3.7	9.0	1.50	5.0	1,000
070 5819	Natural	5.7 to 8.7	10.3	2.30	7.0	2,000
070 5820	Black	5.7 to 8.7	10.3	2.30	7.0	2,000
070 5821	White	5.7 to 8.7	10.3	2.30	7.0	2,000
070 5822	Natural	5.9 to 7.5	19.0	2.36	7.14	5,000
070 3822	Black	5.9 to 7.5	19.0	2.36	7.14	1,000
070 5825	Natural	8.8 to 12.7	19.0	2.36	7.14	1,000
070 3825	Black	8.8 to 12.7	19.0	2.36	7.14	1,000
070 5828	Natural	12.7 to 20.6	19.0	2.36	7.14	1,000
070 3828	Black	12.7 to 20.6	19.0	2.36	7.14	1,000
070 5831	Natural	19.8 to 35.0	19.0	2.36	7.14	1,000
070 5835	Natural	6.0 to 7.5	10.3	1.58	7.14	1,000
070 5838	Natural	8.8 to 12.7	10.3	1.58	7.14	1,000
070 5841	Natural	12.7 to 20.6	10.3	1.58	7.14	1,000

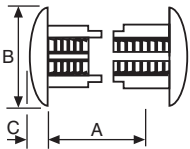

Material: Nylon 66  
RoHS Directive 2002/95/EC compliant



Hole size must be within  $\pm 0.1$  of size quoted in table

When ordering please note that 2 identical rivets are required per fixing

- Simple to use, no tooling required - just press together
- Gives neat finished appearance
- Tamper resistant
- Will not crush or damage soft or brittle materials
- Range to suit various panel thicknesses

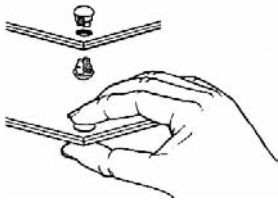

## Binder Posts & Drive Caps

PART NUMBER			L Length	A Head Diameter	B Head Thickness	C Body Diameter	Item	Unit Quantity
Black	White	Clear						
715 3000	715 3001	-	6.35	10.29	2.53	5.59	Post	1,000
715 3007	715 3008	-	9.65	10.29	2.03	5.59	Post	1,000
715 3014	715 3015	-	12.70	10.05	2.03	5.59	Post	1,000
715 3021	715 3022	-	15.75	10.05	2.03	5.59	Post	1,000
715 3028	715 3029	-	19.05	10.05	2.03	5.59	Post	1,000
715 3035	715 3036	-	25.40	10.05	2.03	5.59	Post	1,000
715 3042	715 3043	-	31.75	10.05	2.03	5.59	Post	1,000
715 3049	715 3050	-	38.10	10.05	2.03	5.59	Post	1,000
715 3056	715 3057	-	44.45	10.05	2.03	5.59	Post	1,000
715 3063	715 3064	-	50.80	10.05	2.03	5.59	Post	1,000
715 3070	*715 3071	-	57.15	10.72	2.54	6.35	Post	1,000
715 3076	*715 3077	-	63.50	10.72	2.54	6.35	Post	1,000
715 4000	715 4001	715 4002	6.60	10.82	2.54	3.66	Cap Form A	1,000
715 4007	715 4008	715 4009	11.18	10.84	2.54	3.66	Cap Form B	1,000
715 4014	715 4015	715 4016	10.92	10.99	1.78	3.86	Cap Form C	1,000



Post

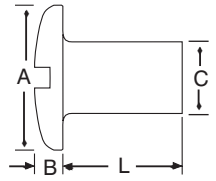

Cap

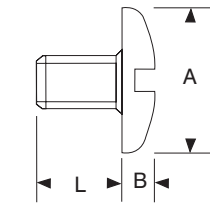

Material:  
Post - Polypropylene  
Cap - Polycarbonate

\* Available in Nylon 66 only

- Lower cost than metal posts and caps
- Faster assembly
- Easily installed with just a hammer tap
- Choice of permanent or removable cap
- Will not damage table tops or stain operator's hands

Posts and Caps are supplied separately

RoHS Directive 2002/95/EC compliant



When ordering please quote Post and Cap numbers required

Tolerances:  $\pm 0.38$

Cap Form A (Removable)

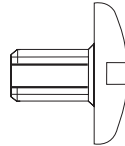

Cap Form B (Removable)

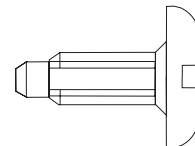

Cap Form C (Permanent Fix)

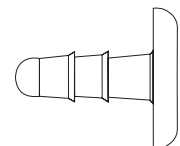

Point of Sale Accessories

## Swatch Fasteners

PART NUMBER		L Length	Item	Unit Quantity
Black	White			
714 1000	714 1001	5	Body	1,000
714 1015	714 1016	8	Body	1,000
714 1020	714 1021	10	Body	1,000
-	714 1026	12	Body	1,000
714 1030	714 1031	15	Body	1,000
714 1040	714 1041	25	Body	1,000
714 1045	714 1046	30	Body	1,000
-	714 1051	35	Body	1,000
714 1065	714 1066	50	Body	1,000
714 2000	714 2001	5	Head	1,000
714 2005	714 2006	10	Head	1,000



Body

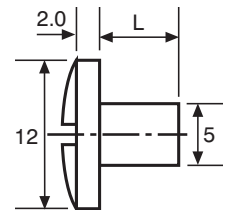

Head

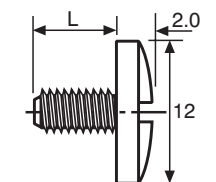

Material:  
High Density Polyethylene

Shouldered Head, Form B, allows intermediate thicknesses to be accommodated. Will fit standard 5mm punched holes

RoHS Directive 2002/95/EC compliant



Thread on head - M4 x 0.7. Body and Head are supplied separately

When ordering please quote body and head part numbers required

- Ideal for binding swatches, cloth, paper, plastics etc
- The unique design allows the head to be snap fitted into the body
- Re-usable
- Provides neat finish on both sides of swatch



## Swatch Fastener Accessories - Handle Grips

PART NUMBER	L Length	W Width	Unit Quantity
714 1526	135.0	3.0	1,000

Material:  
High Density Polyethylene  
Colour: White

- When used in conjunction with Swatch Fasteners these Handles provide an easy means of lifting and displaying assembled materials

RoHS Directive 2002/95/EC compliant

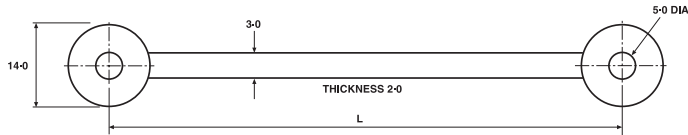

## Swatch Fastener Accessories - Washer

PART NUMBER	Unit Quantity
714 1541	1,000

Material:  
High Density Polyethylene

- Washer spreads load on softer materials

Colour: White

RoHS Directive 2002/95/EC  
compliant

